

ASPHERIC COEFFICIENTS

$$z = \frac{Y^2}{R(1 + \sqrt{1 - (1 + k)Y^2/R^2})} + A_4Y^4$$

| | R | k | A4 |
|----|-------|---------|---------|
| S1 | 9.415 | -0.6392 | 1.7E-05 |
| S2 | PLANO | - | - |

ASPHERIC LENS EQUATION

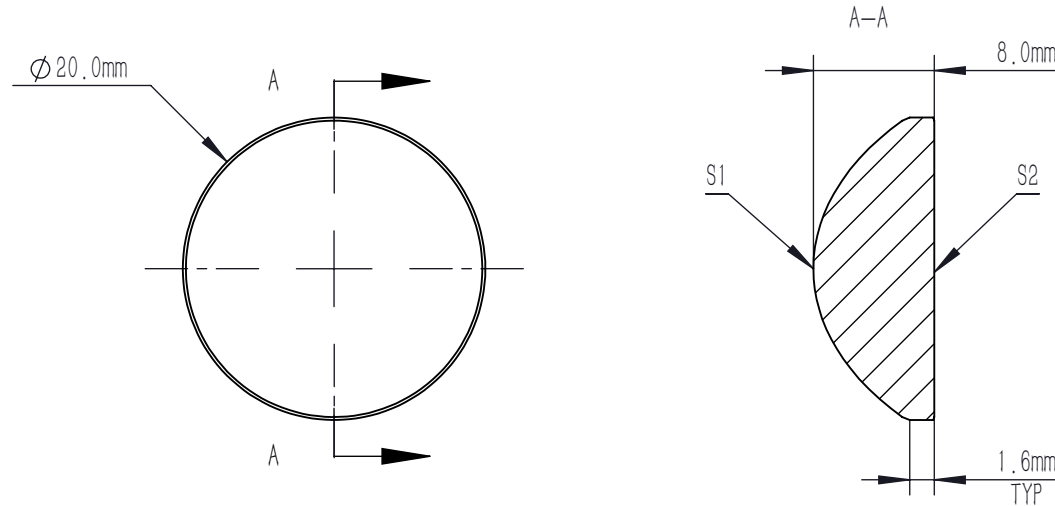

NOTES

1. MATERIAL: B270
2. DESIGN WAVELENGTH: 633.0 nm
3. WORKING WAVELENGTH: 700 nm-1100 nm
4. NUMERICAL APERTURE: 0.52
5. F/#: 1.01
6. FOCAL LENGTH: 18.1 mm
7. FOCAL LENGTH TOLERANCE: ±8%
8. BACK FOCAL LENGTH(REF): bf=13.0 mm
9. CLEAR APERTURE: >90%CA
10. DIAMETER TOLERANCE: +0.0/-0.5 mm
11. THICKNESS TOLERANCE: ±0.3 mm
12. CHAMFER: 0.2 mm, 45°
13. SURFACE QUALITY: 80-50 SCRATCH-DIG
14. CENTRATION: <30 arcmin
15. MAXIMUM TEMPERATURE: 250 °C(482 °F)
16. AR COATING: Ravg<0.5% @ 700 nm-1100 nm, 6° AOI

| | | | | | | |
|--|--------|-------------|--|--------|-------|-----|
| DRAWING PROJECTION | | | LBTEK | | | |
| | | | | | | |
| | NAME | DATE | AC4505-B | | | |
| DRAWN | BSHU | Aug./1st/24 | Ø 20.0 mm, F=18.1 mm, NA=0.52 ASPHERIC CONDENSER LENS AR COATING 700-1100 nm | | | |
| APPROVAL | WCHENG | Aug./1st/24 | MATERIAL | WEIGHT | SCALE | REV |
| FOR INFORMATION ONLY NOT FOR MANUFACTURING PURPOSES | | | B270 | 3.88g | 2:1 | A |