

M40.7 THROUGH TAPPED HOLE  
2 PLACES  
CENTER AXIS ALIGNED TO  
OPTICAL MOUNTING PLANE

NYLON-TIPPED SET SCREW  
FOR SECURING OF MOUNTED OPTIC  
2.0mm [5/64in] HEX

MOUNTING DOUBLE-BORE  
ACCEPTS  $\phi 25.4\text{mm}$  [1.00in] MINIMUM 3.0mm [0.12in] THICK OPTIC VIEW A  
7.0mm [0.28in] DEEP  
 $\phi 23.5\text{mm}$  [0.93in] CLEAR APERTURE

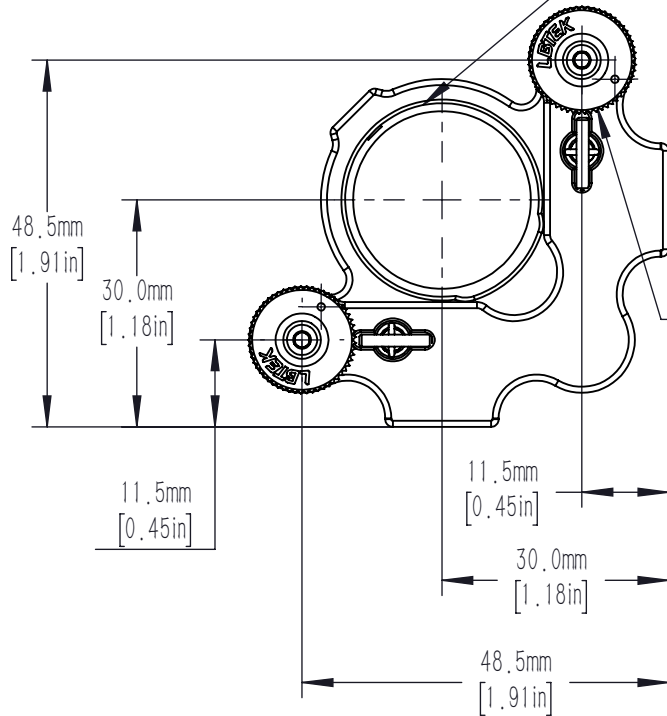

M6X0.25 ADJUSTER SCREWS  
PROVIDES  $\pm 4^\circ$  TOTAL ANGULAR DISPLACEMENT  
( $0.4^\circ$  PER REVOLUTION)  
2 PLACES  
2.0mm [5/64in] HEX

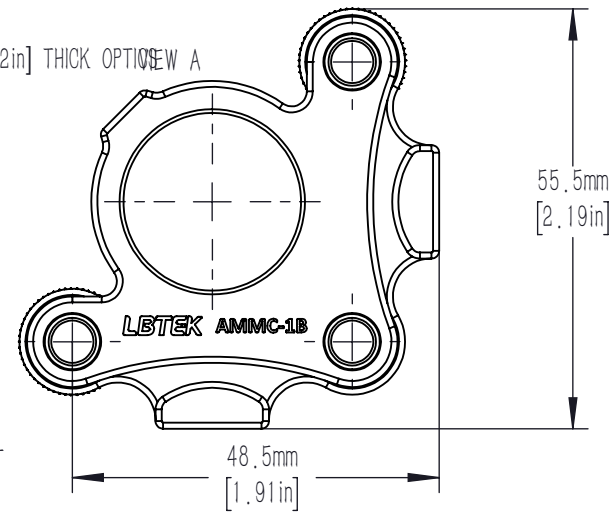

DRAWING PROJECTION			<b>LBTEK</b>			
NAME	DATE	AMMC-1B				
DRAWN	CZH	SEPT./3rd/23	CENTER AXIS ALIGNED MIRROR MOUNT WITH UNTHREADED HOLE FOR $\phi 25.4\text{mm}$ OPTICS			
APPROVAL	ZXU	SEPT./3rd/23	MATERIAL	WEIGHT	SCALE	REV
FOR INFORMATION ONLY NOT FOR MANUFACTURING PURPOSES			N/A	0.082 Kg	1:1	C