

M4X0.7 THROUGH TAPPED HOLE  
2 PLACES  
CENTER AXIS ALIGNED TO  
OPTICAL MOUNTING PLANE

NYLON-TIPPED SET SCREW  
FOR SECURING OF MOUNTED OPTIC  
2.0mm [5/64in] HEX

MOUNTING DOUBLE-BORE  
ACCEPTS  $\phi 50.8\text{mm}$  [ 2.00in] MINIMUM 4.0mm[0.16in] THICK OPTICS  
8.2mm [0.32in] DEEP  
CAGE ROD CLEARNACE BORES  $\phi 48.3\text{mm}$  [ 1.90in] CLEAR APERTURE

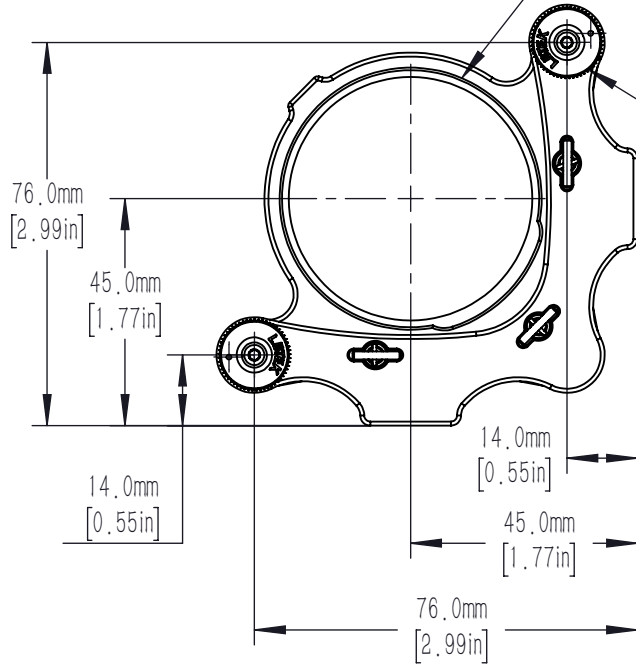

M6X0.25 ADJUSTER SCREWS  
PROVIDES  $\pm 3^\circ$  TOTAL ANGULAR DISPLACEMENT  
( $0.23^\circ$  PER REVOLUTION)  
2 PLACES  
2.0mm [5/64in] HEX

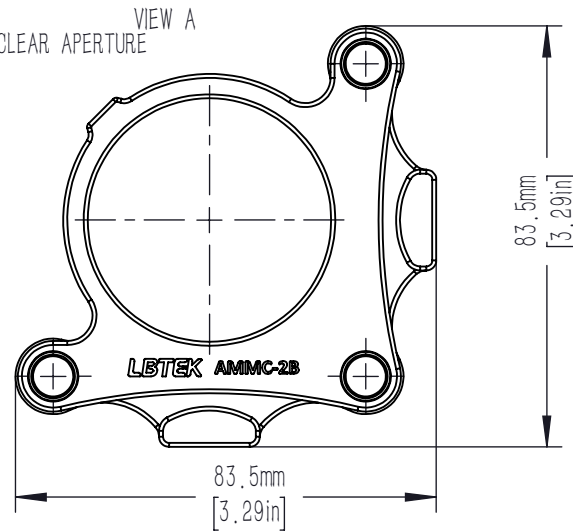

|  |      |              |   |          |       |     |  |
|--|------|--------------|---|----------|-------|-----|--|
| DRAWING PROJECTION                                     |      |              |   |          |       |     |  |
|  | NAME | DATE         | AMMC-2B   |          |       |     |  |
| DRAWN  | CZH  | SEPT./3rd/23 | CENTER AXIS ALIGNED MIRROR MOUNT WITH UNTHREADED HOLE FOR $\phi 50.8\text{mm}$ OPTICS |          |       |     |  |
| APPROVAL   | ZXU  | SEPT./3rd/23 | MATERIAL  | WEIGHT   | SCALE | REV |  |
| FOR INFORMATION ONLY<br>NOT FOR MANUFACTURING PURPOSES |      |              | N/A   | 0.144 Kg | 1:1.5 | C   |  |