

M5X0.25 ADJUSTER SCREWS
 PROVIDES +/-4° TOTAL ANGULAR DISPLACEMENT
 (0.72° PER REVOLUTION)
 2 PLACES
 2.0mm [5/64in] HEX

SM05 (Ø 0.535-40) SERIES INTERNAL THREAD,
 8.9mm (0.35in) DEEP
 1 SM05R RETAINING RING (INCLUDED),
 1.7mm (0.07in) THICK
 Ø 11.4mm [0.45in] CLEAR APERTURE

0.9mm (0.04in) COMPATIBLE
 WITH SPANNER WRENCH
 OWR-05A (NOT INCLUDED)

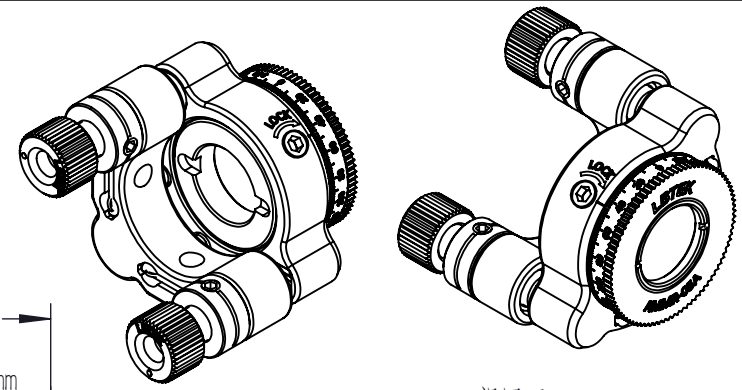
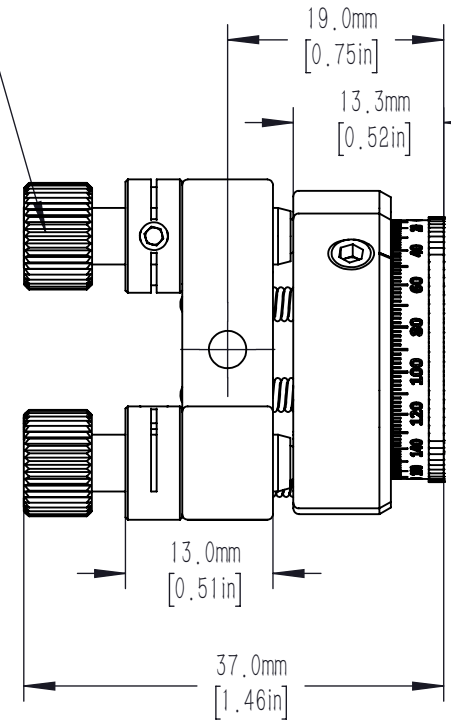
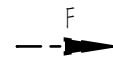
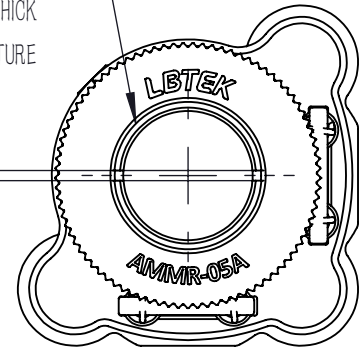

视图 F

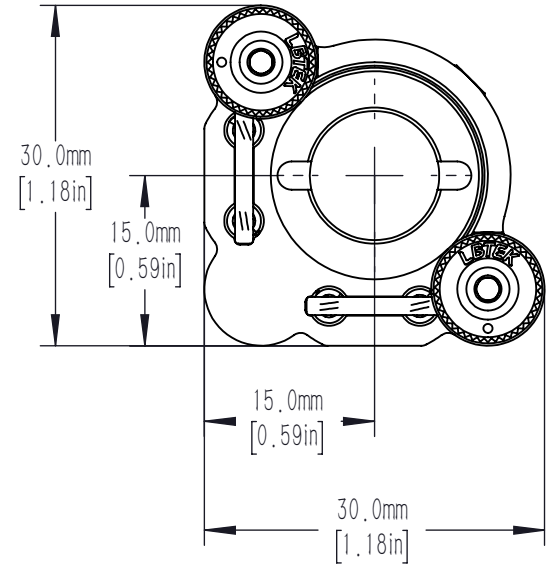

ADJUSTER LOCKING SCREW
 1.5mm HEX
 2 PLACES

M4X0.7 THROUGH TAPPED HOLE
 2 PLACES

ENGRAVED NUMERIC PER 20°
 2° RESOLUTION

LOCKING SCREW FOR ROTATION
 2.0mm(0.08in) HEX
 DO NOT OVERTIGHTEN
 WHEN LOCKING

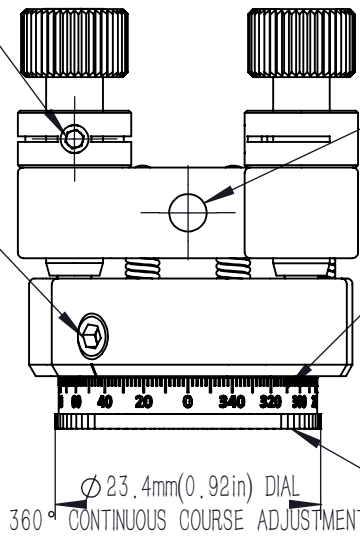

Ø 23.4mm(0.92in) DIAL
 360° CONTINUOUS COURSE ADJUSTMENT

KNURLED SURFACE
 ALLOWS EASY GRIPPING

DRAWING PROJECTION			LBTEK			
	NAME	DATE	AMMR-05A			
DRAWN	YCH	SEP./20th/19	ROTATION MIRROR MOUNT WITH SM05 THREADED FOR Ø 12.7mm OPTICS			
APPROVAL	ERIC	SEP./20th/19	MATERIAL	WEIGHT	SCALE	REV
FOR INFORMATION ONLY NOT FOR MANUFACTURING PURPOSES			N/A	0.04 Kg	1.5:1	B