

A-A  
1.5 : 1

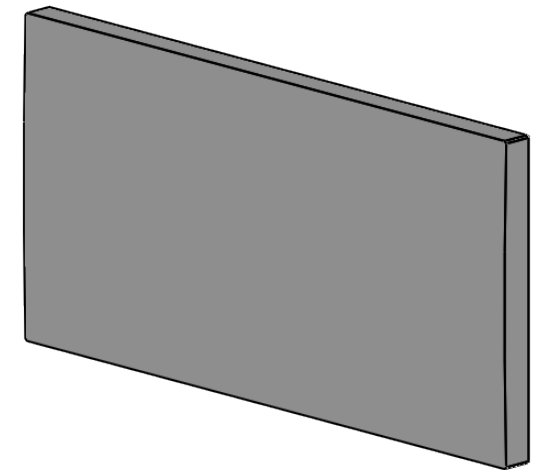

NOTES

1. MATERIAL: N-BK7
2. DESIGN WAVELENGTH: 587.6 nm
3. WORKING WAVELENGTH: 400 nm-700 nm
4. FOCAL LENGTH: 1000.0 mm
5. FOCAL LENGTH TOLERANCE(REF):  $\pm 1\%$
6. BACK FOCAL LENGTH(REF):  $bf=997.9$  mm
7. CLEAR APERTURE:  $>90\%$  OF SURFACE LENGTH AND HEIGHT
8. DIAMETER TOLERANCE:  $+0.0/-0.1$  mm
9. THICKNESS TOLERANCE:  $\pm 0.2$  mm
10. CHAMFER:  $<0.2$  mm,  $45^\circ$
11. SURFACE QUALITY: 60/40 SCRATCH/DIG
12. SURFACE FLATNESS(S1):  $\lambda/2$
13. SURFACE POWER(S2):  $3\lambda/2$
14. SURFACE IRREGULARITY(S2):  $\lambda$  (S2 H),  $\lambda$  (S2 L)
15. CENTRATION:  $\leq 5$  arcmin
16. COATING:  $R_{avg} < 0.5\%$  @ 400 nm-700 nm,  $6^\circ$  AOI

DRAWING PROJECTION							
	NAME	DATE	CY108216-A				
DRAWN	BSHU	JUL./29th/24	$H \times L = 30.0 \text{ mm} \times 60.0 \text{ mm}, f = 1000.0 \text{ mm}$ PLANO CONVEX CYLINDRICAL LENS AR COATING 400-700 nm				
APPROVAL	WCHENG	JUL./29th/24	MATERIAL	WEIGHT	SCALE	REV	
FOR INFORMATION ONLY NOT FOR MANUFACTURING PURPOSES			N-BK7	13.77g	10:1	C	