

VIEW A-A
ROTATED 45°

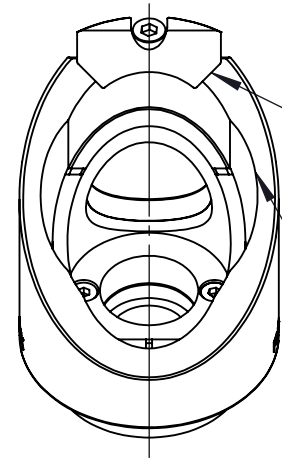

ADJUSTABLE OPTIC CLAMP
 ACCEPTS LONG AXIS 35.9mm
 SHORT SHAFT 25.4mm [1in] OPTICS
 MINIMUM THICKNESS 5.5mm [0.22in]



$\varnothing 10.2\text{mm} [0.40\text{in}]$ THRU
 MOUNTING BORE TO BE USED
 WITH STANDARD 1/4" WASHER

$\varnothing 10.2\text{mm} [0.40\text{in}]$
 CLEAR APERTURE

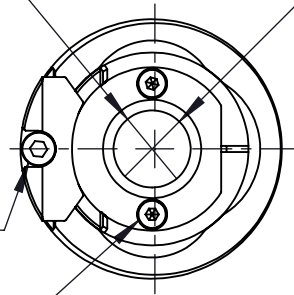

M2.5x10 REMOVABLE
 CLAMPING SCREW
 2mm [5/64in] HEX (INCLUDED)

DO NOT REMOVE
 2PCS SCREW

DRAWING PROJECTION			LBTEK			
	NAME	DATE				
DRAWN	ZXU	OCT./23th/20	FIXED 45° MIRROR HOLDER FOR 1" ELLIPTICAL OPTICS			
APPROVAL	YCH	OCT./23th/20	MATERIAL	WEIGHT	SCALE	REV
FOR INFORMATION ONLY NOT FOR MANUFACTURING PURPOSES			N/A	0.044 Kg	1:1	B