

M2 TAP THRU
USE TO MOUNT FIBERPORT
4 PLACES

4X $\phi 6.0\text{mm}$ [0.24in] THRU HOLES
FOR USE WITH MOP SERIES RODS

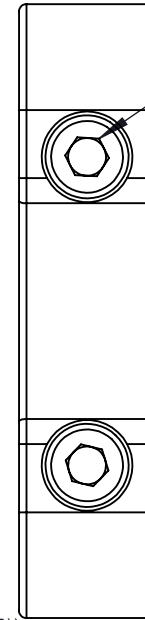

4x CAGE ROD LOCKING SCREW
2.0mm [0.06in] HEX

SM1 (1.035"-40) SERIES INTERNAL THREAD THRU
TWO SM1R RETAINING RINGS INCLUDED
 $\phi 23\text{mm}$ [0.91in] CLEAR APERTURE



DRAWING PROJECTION			LBTEK			
NAME	DATE	FOPM-9B				
DRAWN	CZH	DEC./7th/23	30 mm FLEXIBLE COAXIAL MOUNTING PLAT			
APPROVAL	HDE	DEC./7th/23	MATERIAL	WEIGHT	SCALE	REV
FOR INFORMATION ONLY NOT FOR MANUFACTURING PURPOSES			N/A	0.025 Kg	2:1	B