

注:

1. 元件材质: 液晶聚合物/N-BK7窗口片
2. 元件直径: $\varnothing 25.4 +0/-0.1$ mm
3. 元件厚度: 3.2 ± 0.05 mm
4. 切边宽度: 1.5 ± 0.05 mm
5. 透光孔径: 15×15 mm
6. 工作波长: 1064 nm
7. 像素尺寸: 36×36 um
8. 延迟量: $\lambda/2 \pm 5$ nm
9. 透过率: $>98\%$
10. 透射波前差: $< \lambda/4 @ 633$ nm
11. 表面光洁度 (划痕/麻点): 60/40
12. 增透膜(S1, S2): $R_{avg} < 0.5\% @ 700-1100$ nm

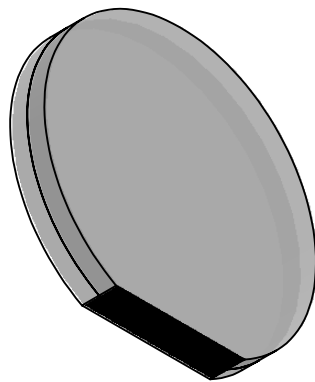

DRAWING PROJECTION			LBTEK			
	NAME	DATE	LCCG25-1064-36			
DRAWN	SHAN	SEP./27th/22	Checkerboard Grating			
APPROVAL	XLIU	SEP./27th/22	MATERIAL	WEIGHT	SCALE	REV
FOR INFORMATION ONLY NOT FOR MANUFACTURING PURPOSES			LCP/N-BK7	0.004 Kg	2:1	A