

注:

1. 元件材质: 液晶聚合物/N-BK7窗口片
2. 元件直径: $\varnothing 25.4 +0/-0.1\text{ mm}$
3. 元件厚度: $3.2 \pm 0.05\text{ mm}$
4. 切边宽度: $1.5 \pm 0.05\text{ mm}$
5. 透光孔径: $15 \times 15\text{ mm}$
6. 工作波长: 633 nm
7. 像素尺寸: $36 \times 36\text{ um}$
8. 延迟量: $\lambda/2 \pm 5\text{ nm}$
9. 透过率: $>97\%$
10. 透射波前差: $< \lambda/4 @ 633\text{ nm}$
11. 表面光洁度 (划痕/麻点): $60/40$
12. 增透膜(S1, S2): $R_{\text{avg}} < 0.5\% @ 400-700\text{ nm}$

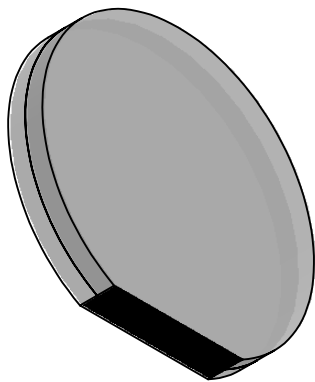

DRAWING PROJECTION			LBTEK			
	NAME	DATE	LCCG25-633-36			
DRAWN	SHAN	SEP./27th/22	Checkerboard Grating			
APPROVAL	XLIU	SEP./27th/22	MATERIAL	WEIGHT	SCALE	REV
FOR INFORMATION ONLY NOT FOR MANUFACTURING PURPOSES			LCP/N-BK7	0.004 Kg	2:1	A