

	PART DESCRIPTION	MATERIAL
①	SM2-50A	ANODIZED ALUMINIUM
②	AD510-C	N-LAK22
		N-SF6HT
③	SM2R	ANODIZED ALUMINIUM

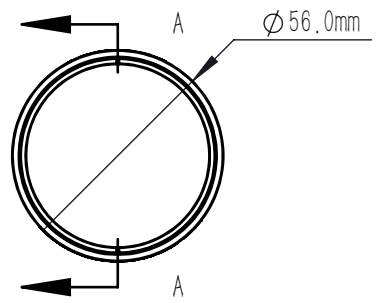
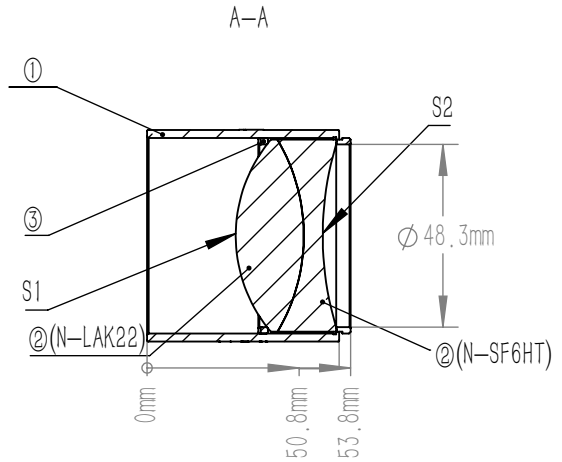

NOTES

- MATERIAL: N-LAK22/N-SF6HT
- DESIGN WAVELENGTH: 1016.0 nm, 1330.0 nm & 1550.0 nm
- CLEAR APERTURE: >90%CA
- OPERATION WAVELENGTH: 1100 nm-1650 nm
- DIAMETER TOLERANCE: +0.0/-0.1 mm
- THICKNESS TOLERANCE: ±0.2 mm
- FOCAL LENGTH: 150.0 mm ±1%@1330.0 nm
- BACK FOCAL LENGTH(REF): 117.7 mm
- SURFACE QUALITY (S/D) (S1,S2) : 40/20
- SURFACE POWER (S1,S2) :  $3\lambda/2@632.8\text{ nm}$
- SURFACE IRREGULARITY(S1,S2):  $\lambda/4@632.8\text{ nm}$
- CENTRATION: <3 arcmin
- CHAMFER: <0.2 mm, 45°
- COATING (S1,S2) : AR COATING  $R_{\text{avg}} < 0.5\% @ 1100\text{ nm}-1650\text{ nm}$

DRAWING PROJECTION			<b>LBTEK</b>			
		NAME	DATE	MAD510-C		
DRAWN	BSHU	Aug./5th/24	$\phi 50.8\text{ mm}, F=150.0\text{ mm}$ ACHROMATIC DOUBLETS AR COATING 1100-1650 nm			
APPROVAL	WCHENG	Aug./5th/24	MATERIAL	WEIGHT	SCALE	REV
FOR INFORMATION ONLY NOT FOR MANUFACTURING PURPOSES			N-LAK22/N-SF6	197.95g	1:2	B