

	PART DESCRIPTION	MATERIAL
①	SM2-16.5A	ANODIZED ALUMINIUM
②	AD528-A	N-BK7
		N-SF2
③	SM2R	ANODIZED ALUMINIUM

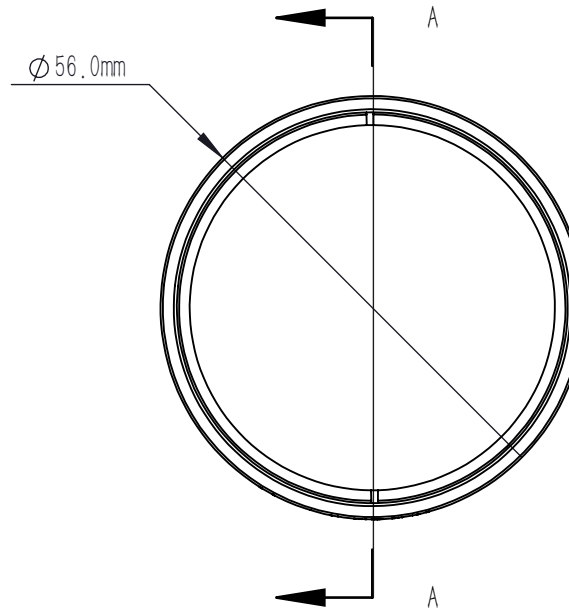
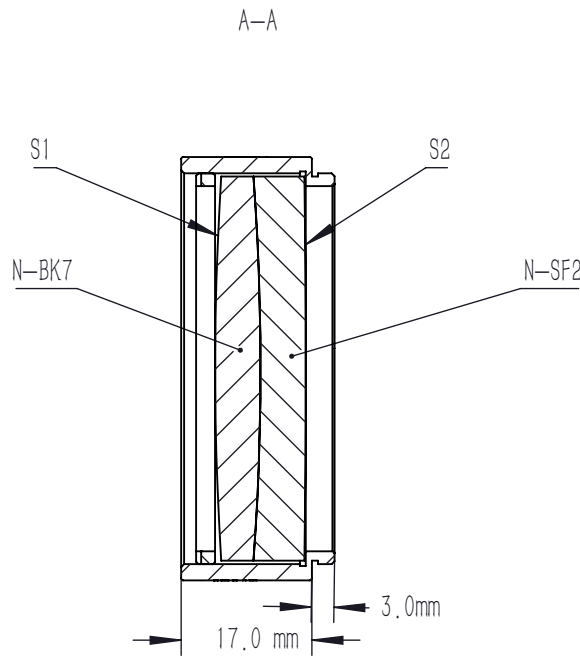

NOTES

- MATERIAL: N-BK7/N-SF2
- DESIGN WAVELENGTH: 486.1 nm, 587.6 nm & 656.3 nm
- CLEAR APERTURE: >90%CA
- OPERATION WAVELENGTH: 400 nm-700 nm
- DIAMETER TOLERANCE: +0.0/-0.1 mm
- THICKNESS TOLERANCE: ±0.2 mm
- FOCAL LENGTH: 750.0 mm ±1%@587.6 nm
- BACK FOCAL LENGTH(REF): 743.9 mm
- SURFACE QUALITY (S/D) (S1,S2): 40/20
- SURFACE POWER (S1,S2): $3\lambda/2@632.8\text{ nm}$
- SURFACE IRREGULARITY(S1,S2): $\lambda/4@632.8\text{ nm}$
- CENTRATION: <3 arcmin
- CHAMFER: <0.2 mm, 45°
- COATING (S1,S2): AR COATING $R_{avg}<0.5\%@400\text{ nm}-700\text{ nm}$

DRAWING PROJECTION			LBTEK			
			MAD528-A			
DRAWN	BSHU	Aug./5th/24	$\Phi 50.8\text{ mm}$, $F=750.0\text{ mm}$ ACHROMATIC DOUBLETS AR COATING 400-700 nm			
APPROVAL	WCHENG	Aug./5th/24	MATERIAL	WEIGHT	SCALE	REV
FOR INFORMATION ONLY NOT FOR MANUFACTURING PURPOSES			N-BK7/N-SF2	84.43g	1:1	B