

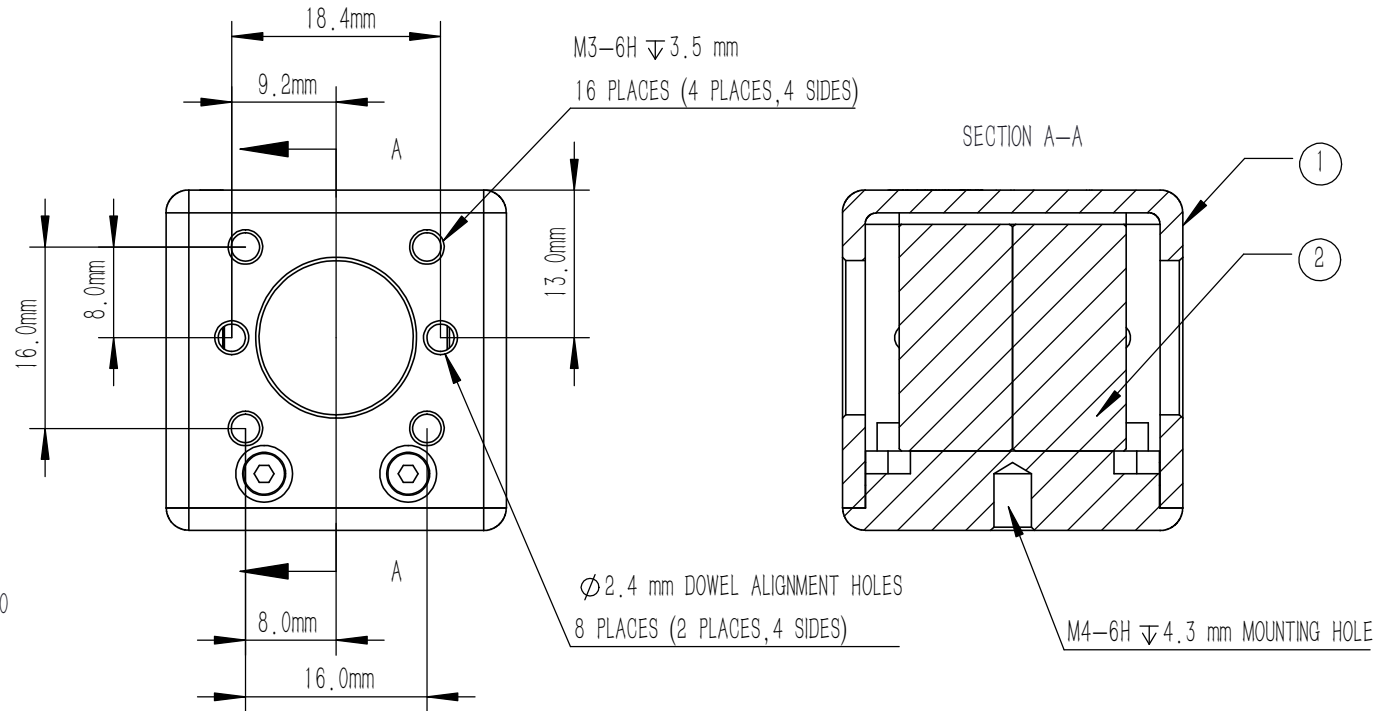

NUMBER	PART DESCRIPTION	MATERIAL
①	MECHANICAL HOUSING	BLACK ANODIZED ALUMINUM
②	BS1391-A	N-BK7



NOTES

BS1391-A:

1. CLEAR APERTURE: >80%CA
2. AR COATING (S1, S2, S3, S4) :  $R_{avg} < 0.5\%$  @400 nm-700 nm (6° AOI, SINGLE SURFACE)
3. ANGLE TOLERANCE:  $\pm 5'$
4. COATING (S5) : SPLITTING COATING  
 $T_{abs} = (7 + 10/-7)\%$ ,  $R_{abs} = (87 \pm 10)\%$ ;  
 $|T_s - T_p| < 10\%$ ,  $|R_s - R_p| < 10\%$ ;  $T_{abs} + R_{abs} > 85\%$
5. GLUED (S5, S6) : NOA61
6. SPLIT RATIO (R:T) : 90:10
7. TRANSMITTED BEAM DEVIATION:  $0^\circ \pm 5$  arcmin
8. REFLECTED BEAM DEVIATION:  $90^\circ \pm 5$  arcmin
9. SURFACE QUALITY (S1, S2, S3, S4) : 40/20 (S/D)
10. WAVEFRONT ERROR(RMS):  $\lambda/4@633$  nm
11. SURFACE FLATNESS (S1, S2, S3, S4) :  $\lambda/4@633$  nm
12. OTHER SURFACES: FINE GROUND
13. CHAMFER: 0.2 mm, 45°

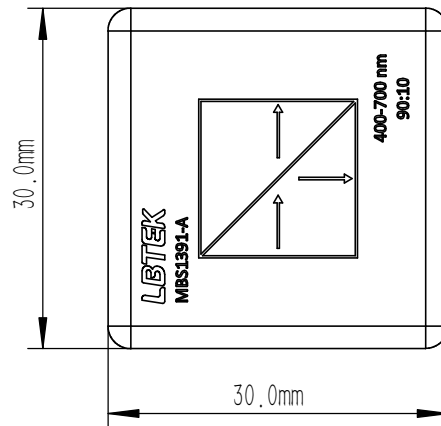

DRAWING PROJECTION				<h1 style="color: red; margin: 0;">LBTEK</h1>			
	NAME	DATE	MBS1391-A				
DRAWN	LZHOU	MAR./12th/24	BEAM SPLITTER L=20.0 mm, R:T=90:10@400 nm-700 nm				
APPROVAL	WCHENG	MAR./12th/24	MATERIAL	WEIGHT	SCALE	REV	
FOR INFORMATION ONLY NOT FOR MANUFACTURING PURPOSES			6061-T6&N-BK7	49.1 g	3:2	A	