

| NUMBER | PART DESCRIPTION | MATERIAL |
|--------|--------------------|-------------------------|
| ① | MECHANICAL HOUSING | BLACK ANODIZED ALUMINUM |
| ② | BS1437-B | N-BK7 |

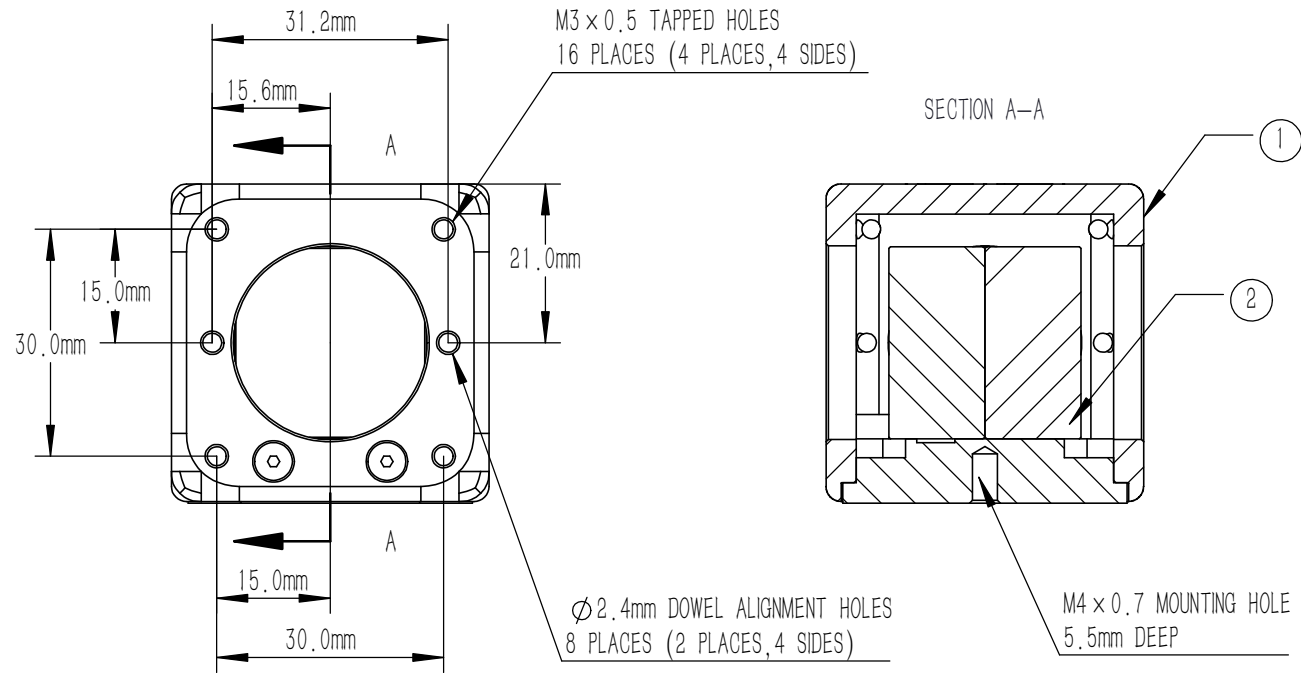
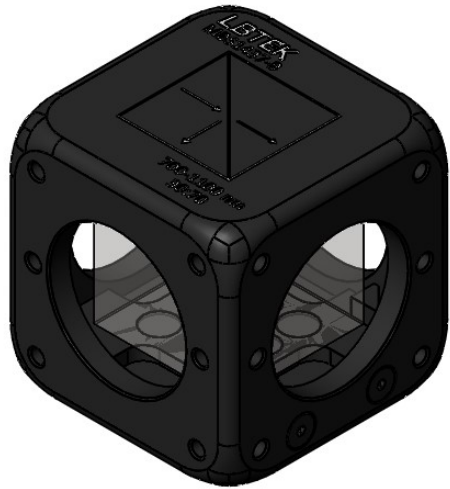

NOTES

BS1437-B:

1. CLEAR APERTURE: >80%CA
2. AR COATING(S1,S2,S3,S4): $R_{avg} < 0.5\%$ @700 nm-1100 nm (6° AOI, SINGLE SURFACE)
3. ANGLE TOLERANCE: $\pm 5'$
4. COATING(S5):
 $T_{abs} = (62 \pm 10)\%$, $R_{abs} = (27 \pm 10)\%$;
 $|T_s - T_p| < 10\%$, $|R_s - R_p| < 10\%$;
 $T_{abs} + R_{abs} > 80\%$
5. GLUED(S5,S6): NOA61
6. SPLIT RATIO(R:T): 30:70
7. TRANSMITTED BEAM DEVIATION: $0^\circ \pm 5$ arcmin
8. REFLECTED BEAM DEVIATION: $90^\circ \pm 5$ arcmin
9. SURFACE QUALITY(S1,S2,S3,S4): 40/20(S/D)
10. WAVEFRONT ERROR(RMS): $\lambda/4$ @633 nm
11. SURFACE FLATNESS(S1,S2,S3,S4): $\lambda/6$ @633 nm
12. OTHER SURFACES: FINE GROUND
13. CHAMFER: 0.2 mm, 45°

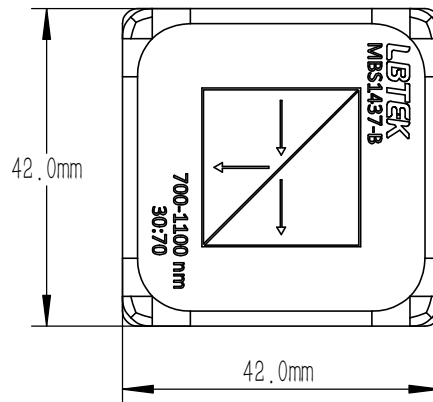

| | | | | | | | |
|--------------------|--|--------|--|----------------------|--|-------------------------------------|--|
| DRAWING PROJECTION | | | | LBTEK | | | |
| | | | | MBS1437-B | | | |
| DRAWN | | LTAN | | DATE | | Oct./10th/24 | |
| APPROVAL | | WCHENG | | DATE | | Oct./10th/24 | |
| | | | | BEAM SPLITTER | | L=25.4 mm, R:T=30:70@700 nm-1100 nm | |
| | | | | FOR INFORMATION ONLY | | NOT FOR MANUFACTURING PURPOSES | |
| | | | | MATERIAL | | WEIGHT | |
| | | | | SCALE | | REV | |
| | | | | N-BK7 | | 129 g | |
| | | | | 1:1 | | B | |