

NUMBER	PART DESCRIPTION	MATERIAL
①	MECHANICAL HOUSING	BLACK ANODIZED ALUMINUM
②	BS1473-B	N-BK7

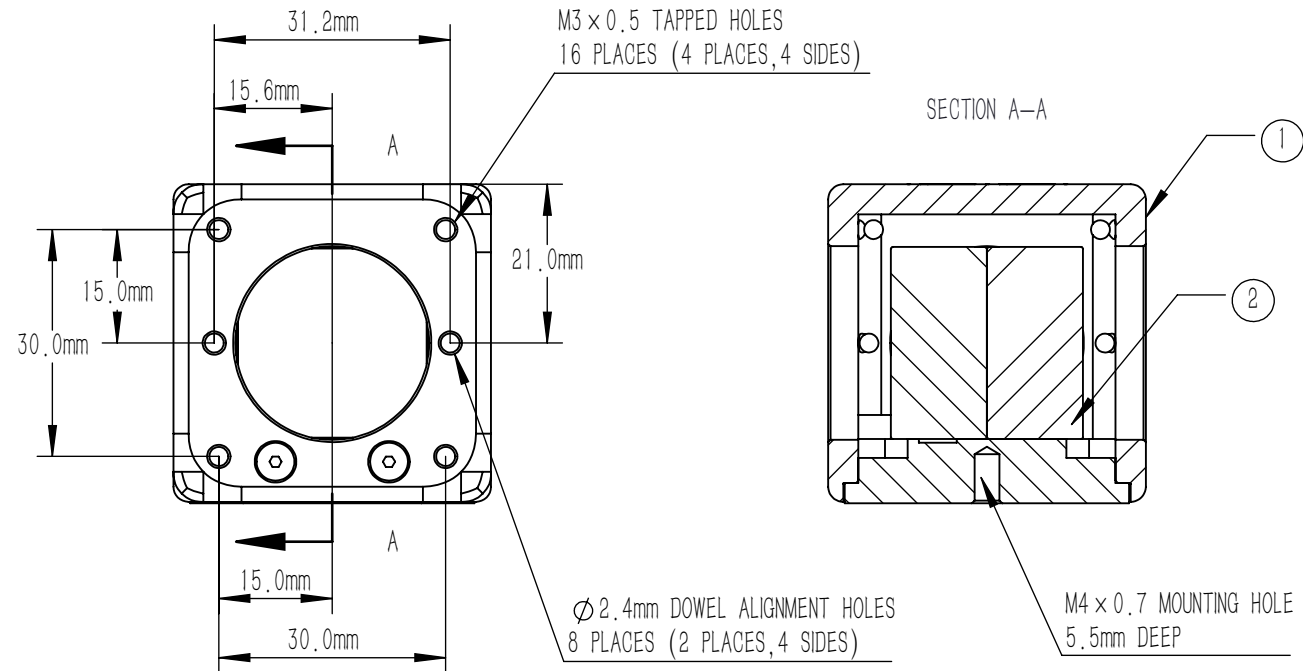

NOTES

BS1473-B.

1. CLEAR APERTURE: 80% CA
2. AR COATING(S1,S2,S3,S4): $R_{avg} < 0.5\% @ 700 \text{ nm} - 1100 \text{ nm}$
(6° AOI, SINGLE SURFACE)
3. ANGLE TOLERANCE: $\pm 5'$
4. COATING(S5): SPLITTING COATING
 $T_{abs} = (27 \pm 10)\%$, $R_{abs} = (67 + 5 / -15)\%$,
 $|T_s - T_p| < 10\%$, $|R_s - R_p| < 10\%$, $T_{abs} + R_{abs} > 85\%$, $AOI = 0^\circ$
5. GLUED(S5,S6): NOA61
6. SPLIT RATIO(R:T): 70:30
7. TRANSMITTED BEAM DEVIATION: $0^\circ \pm 5 \text{ arcmin}$
8. REFLECTED BEAM DEVIATION: $90^\circ \pm 5 \text{ arcmin}$
9. SURFACE QUALITY(S1,S2,S3,S4): 40/20(S/D)
10. WAVEFRONT ERROR: $\lambda/4 @ 633 \text{ nm}$
11. SURFACE FLATNESS(S1,S2,S3,S4): $\lambda/6 @ 633 \text{ nm}$
12. OTHER SURFACES: FINE GROUND
13. CHAMFER: 0.2 mm, 45°

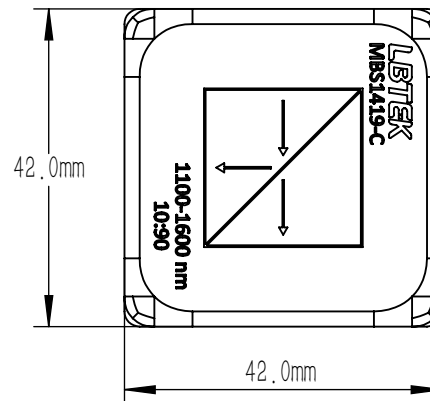

DRAWING PROJECTION				LBTEK			
		NAME	DATE	MBS1473-B			
DRAWN	LTAN	Oct./10th/24	BEAM SPLITTER L=25.4 mm, R:T=70:30@700 nm-1100 nm				
APPROVAL	WCHENG	Oct./10th/24	MATERIAL	WEIGHT	SCALE	REV	
FOR INFORMATION ONLY NOT FOR MANUFACTURING PURPOSES			N-BK7	129 g	1:1	B	