

NUMBER	PART DESCRIPTION	MATERIAL
①	MECHANICAL HOUSING	BLACK ANODIZED ALUMINUM
②	BS1473-C	N-BK7

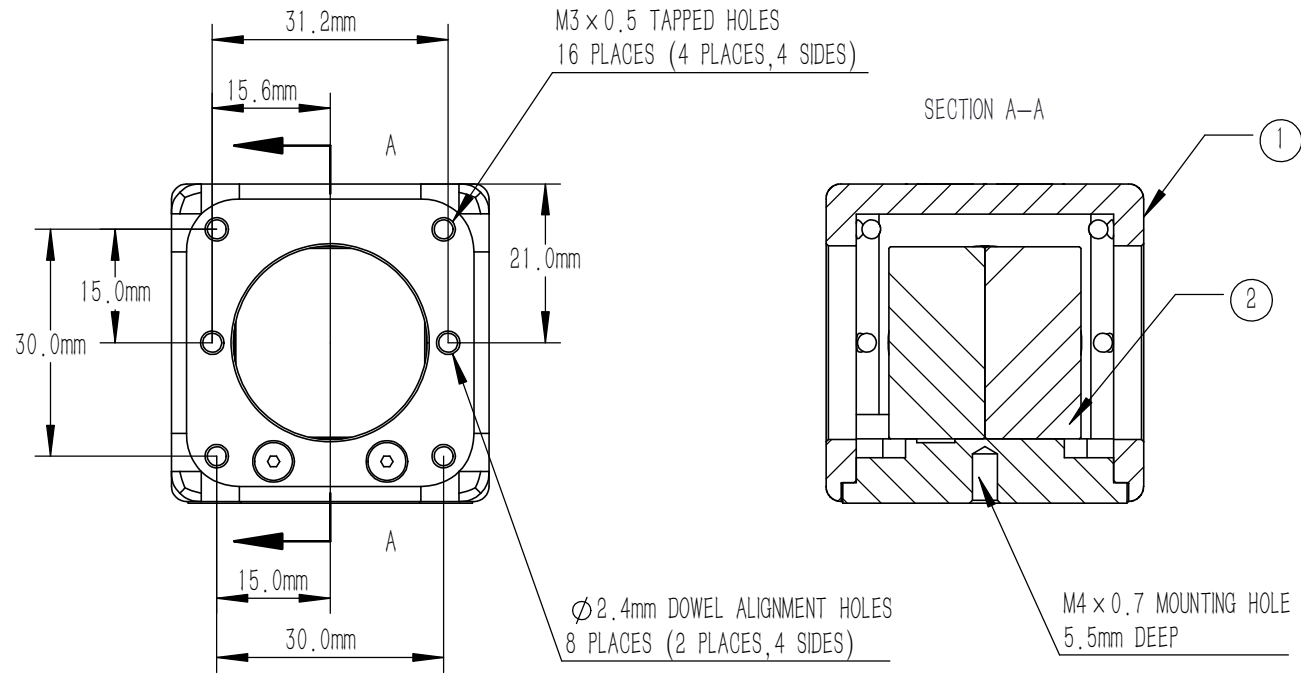

NOTES

BS1473-C.

- CLEAR APERTURE: 80% CA
- AR COATING(S1, S2, S3, S4):  $R_{avg} < 0.5\%$  @ 1100 nm-1600nm (6° AOI, SINGLE SURFACE)
- ANGLE TOLERANCE:  $\pm 5'$
- COATING(S5): SPLITTING COATING  
 $T_{abs} = (27 \pm 10)\%$ ,  $R_{abs} = (67 + 5 / -15)\%$ ,  
 $|T_s - T_p| < 10\%$ ,  $|R_s - R_p| < 10\%$ ,  $T_{abs} + R_{abs} > 85\%$
- GLUED(S5, S6): NOA61
- SPLIT RATIO(R, T): 70:30
- TRANSMITTED BEAM DEVIATION:  $0^\circ \pm 5$  arcmin
- REFLECTED BEAM DEVIATION:  $90^\circ \pm 5$  arcmin
- SURFACE QUALITY(S1, S2, S3, S4): 40/20(S/D)
- WAVEFRONT ERROR:  $\lambda/4 @ 633$  nm
- SURFACE FLATNESS(S1, S2, S3, S4):  $\lambda/6 @ 633$  nm
- OTHER SURFACES: FINE GROUND
- CHAMFER: 0.2 mm, 45°

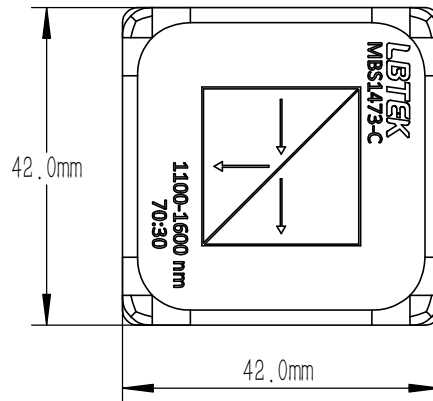

DRAWING PROJECTION							
	NAME	DATE	<b>MBS1473-C</b>				
DRAWN	LTAN	Oct. /10th/24	BEAM SPLITTER L=25.4 mm, R:T=70:30@1100 nm-1600nm				
APPROVAL	WCHENG	Oct. /10th/24	MATERIAL	WEIGHT	SCALE	REV	
FOR INFORMATION ONLY NOT FOR MANUFACTURING PURPOSES			N-BK7	129 g	1:1	B	