

$\overset{0}{\phi} 25.4\text{mm} -0.1$

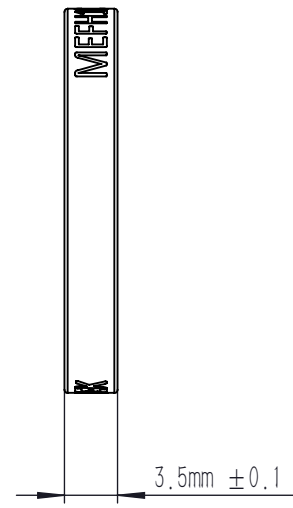
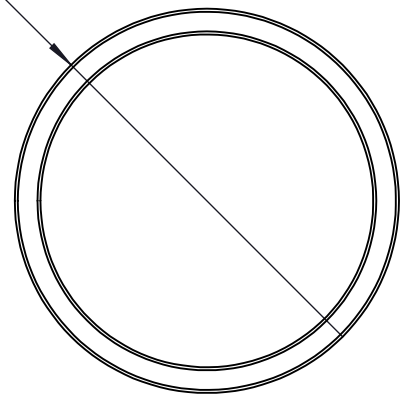

NOTE

1. CUT-ON(CUT-OFF) WAVELENGTH: 1000 nm
2. CLEAR APERTURE: 22 mm
3. TRANSMITTED WAVEFRONT ERROR: $\lambda/2@633$ nm
4. SURFACE QUALITY: 60/40 SCRATCH-DIG
5. COATING: Tabs >90% @ 500 nm-987 nm, 0° AOI
OD(avg) >5 @ 1013 nm-1480 nm, 0° AOI

DRAWING PROJECTION			LBTEK			
	NAME	DATE	MEFH10-1000SP			
DRAWN	LZHOU	JUL./29th/24	SHORTPASS FILTER $\phi 25.4$ mm x 3.5 mm, 1000 nm			
APPROVAL	WCHENG	JUL./29th/24	MATERIAL	WEIGHT	SCALE	REV
FOR INFORMATION ONLY NOT FOR MANUFACTURING PURPOSES			UV FUSED SILICA&ALUMINUM	3g	2:1	C