

$\overset{0}{\phi} 25.4\text{mm} -0.1$

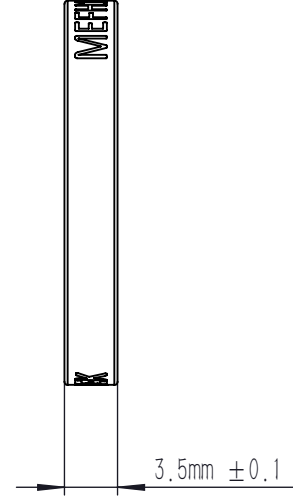
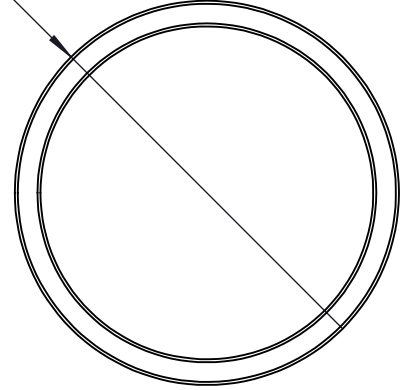

NOTE

1. CUT-ON(CUT-OFF) WAVELENGTH: 450 nm
2. CLEAR APERTURE: 22 mm
3. TRANSMITTED WAVEFRONT ERROR: $\lambda/2@633$ nm
4. SURFACE QUALITY: 60/40 SCRATCH-DIG
5. COATING: Tabs>90%@457 nm-2100 nm, 0° AOI
OD(avg)>5@200 nm-443 nm, 0° AOI

DRAWING PROJECTION			LBTEK			
	NAME	DATE				
DRAWN	LZHOU	JUL./29th/24	LONGPASS FILTER $\phi 25.4$ mm \times 3.5 mm, 450 nm			
APPROVAL	WCHENG	JUL./29th/24	MATERIAL	WEIGHT	SCALE	REV
FOR INFORMATION ONLY NOT FOR MANUFACTURING PURPOSES			UV FUSED SILICA&ALUMINUM	3g	2:1	C