

$\overset{0}{\phi} 25.4\text{mm} -0.1$

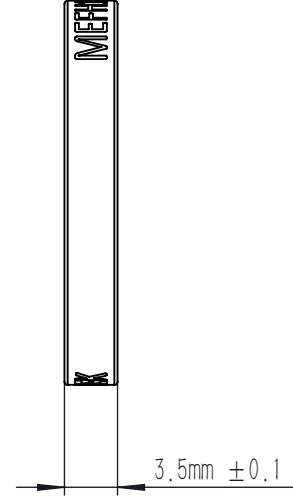
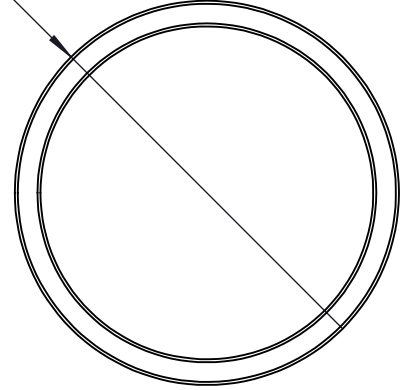

NOTE

1. CUT-ON(CUT-OFF) WAVELENGTH: 700 nm
2. CLEAR APERTURE: 22 mm
3. TRANSMITTED WAVEFRONT ERROR:  $\lambda/2@633$  nm
4. SURFACE QUALITY: 60/40 SCRATCH-DIG
5. COATING: Tabs>85%@400 nm-420 nm, 0° AOI  
 Tabs>90%@420 nm-690 nm, 0° AOI  
 OD(avg)>5@711 nm-1180 nm, 0° AOI

DRAWING PROJECTION			<b>LBTEK</b>			
	NAME	DATE	MEFH10-700SP			
DRAWN	LZHOU	JUL./29th/24	SHORTPASS FILTER $\phi 25.4$ mm x 3.5 mm, 700 nm			
APPROVAL	WCHENG	JUL./29th/24	MATERIAL	WEIGHT	SCALE	REV
FOR INFORMATION ONLY NOT FOR MANUFACTURING PURPOSES			UV FUSED SILICA&ALUMINUM	3g	2:1	C