

$\overset{0}{\phi} 25.4\text{mm} -0.1$

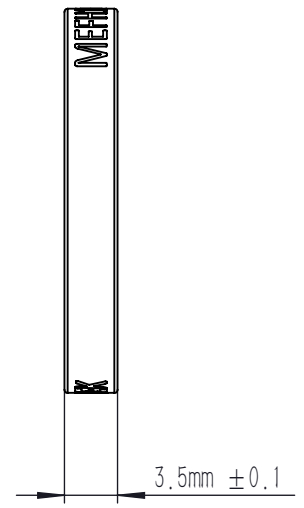
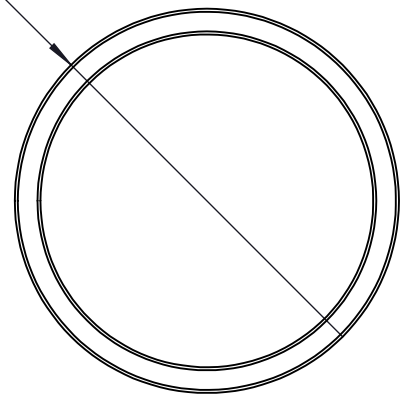

NOTE

1. CUT-ON(CUT-OFF) WAVELENGTH: 800 nm
2. CLEAR APERTURE: 22 mm
3. TRANSMITTED WAVEFRONT ERROR:  $\lambda/2@633$  nm
4. SURFACE QUALITY: 60/40 SCRATCH-DIG
5. COATING: Tabs>90%@812 nm-2100 nm, 0° AOI  
OD(avg)>5@200 nm-789 nm, 0° AOI

|  |        |              |   |        |       |     |
|--|--------|--------------|---|--------|-------|-----|
| DRAWING PROJECTION                                     |        |              | <b>LBTEK</b>  |        |       |     |
|  | NAME   | DATE         | MEFH10-800LP  |        |       |     |
| DRAWN  | LZHOU  | JUL./29th/24 | LONGPASS FILTER<br>$\phi 25.4$ mm $\times$ 3.5 mm, 800 nm |        |       |     |
| APPROVAL   | WCHENG | JUL./29th/24 | MATERIAL  | WEIGHT | SCALE | REV |
| FOR INFORMATION ONLY<br>NOT FOR MANUFACTURING PURPOSES |        |              | UV FUSED SILICA&ALUMINUM                                  | 3g     | 2:1   | C   |