

CENTER OF GRAVITY MOUNTED TO MKB-50 SHOULD BE LOCATED WITHIN MOUNTING REGION FOR MAXIMUM STABILITY

HIGH STRENGTH MAGNET
4 PLACES

V-GROOVE
3 PLACES

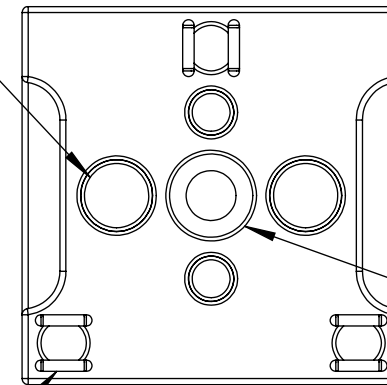

BOTTOM PLATE (MKB-50-B)

COUNTREBORE FOR USE WITH M6 CAP SCREW (INCLUDED)

HIGH STRENGTH MAGNET
4 PLACES

STEEL BALL TO MATE WITH V-GROOVE
3 PLACES

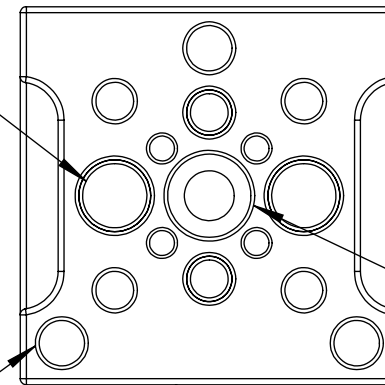

OP PLATE (MKB-50-A)

COUNTREBORE FOR USE WITH M6 CAP SCREW (INCLUDED)

DRAWING PROJECTION			LBTEK			
	NAME	DATE				
DRAWN	HDE	SEP./21th/22	50MM MAGNETIC KINEMATIC BAS			
APPROVAL	ZXY	SEP./21th/22	MATERIAL	WEIGHT	SCALE	REV
FOR INFORMATION ONLY NOT FOR MANUFACTURING PURPOSES			ALUMINUM	0.155 Kg	1:1	B