

NUMBER	PART DESCRIPTION	MATERIAL
①	MECHANICAL HOUSING	BLACK ANODIZED ALUMINUM
②	PBS24-633	UVFS

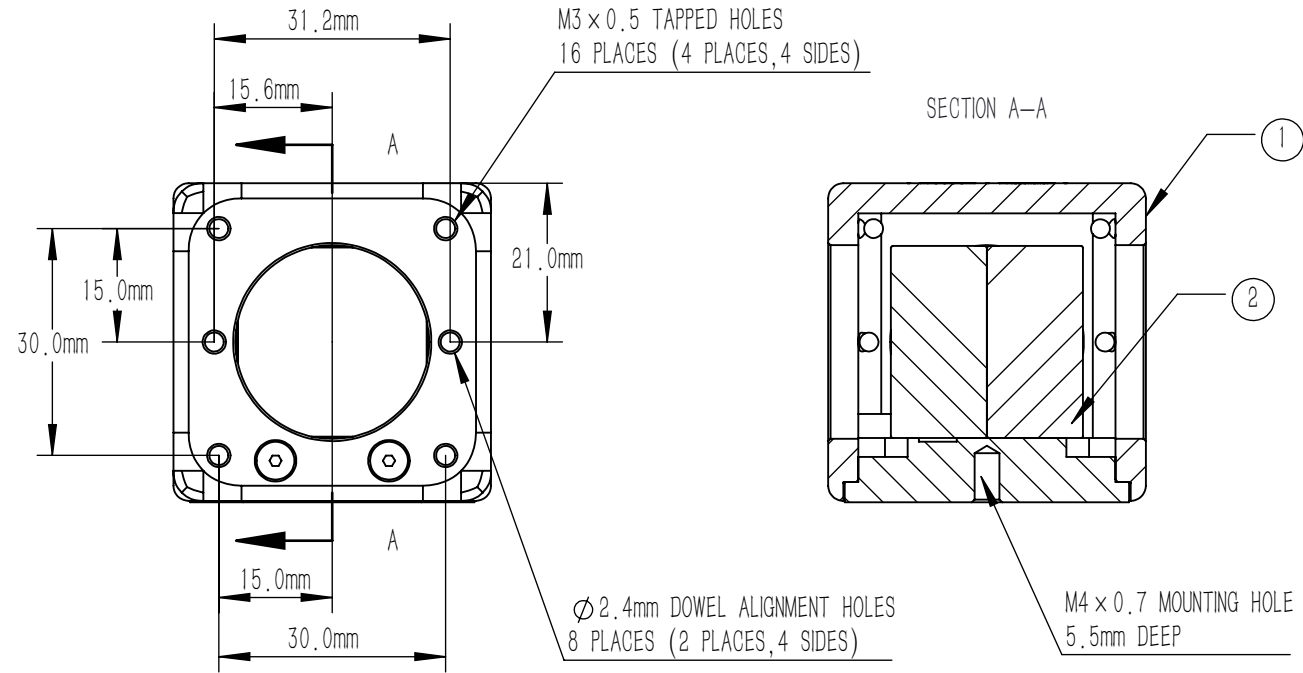

NOTES

PBS24-633:

1. CLEAR APERTURE: $>80\%$ WxL
2. DIAMETER TOLERANCE: $+0.0/-0.1$ mm
3. EXTINCTION RATIO(T_p, T_s): $>3000:1$
4. DESIGN WAVELENGTH: 633 nm
5. TRANSMITTED BEAM DEVIATION: ≤ 5 arcmin
6. REFLECTED BEAM DEVIATION: $\leq 90^\circ \pm 5$ arcmin
7. SURFACE QUALITY(S/D): 20/10
8. WAVEFRONT ERROR(RMS): $< \lambda/4@633$ nm
9. PARALLELISM(S1, S2, S3, S4): ≤ 10 arcsec
10. AR COATING(S1, S2, S3, S4): V Coating @633 nm, Rabs: $<0.25\%$, 0° AOI
11. S POLARIZATION REFLECTION: $>99.5\%$
12. P POLARIZATION TRANSMISSION: $>95\%$
13. CHAMFER: <0.5 mm $\times 45^\circ$
14. OPERATING TEMPERATURE: $-50^\circ \sim 90^\circ$
15. GLUED(S5, S6): NOA61

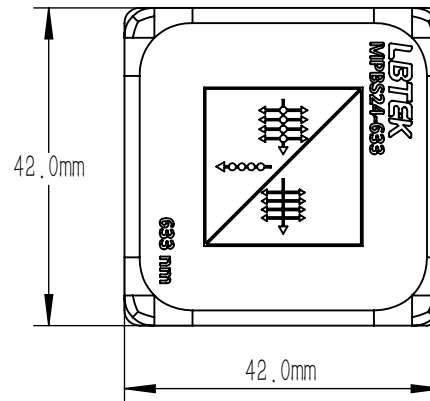

DRAWING PROJECTION				LBTEK			
	NAME	DATE	MPBS24-633				
DRAWN	LZHOU	AUG./12th/24	LASER LINE POLARIZATION BEAM SPLITTE L=25.4 mm, $T_p, T_s > 3000:1@633$ nm				
APPROVAL	WCHENG	AUG./12th/24	MATERIAL	WEIGHT	SCALE	REV	
FOR INFORMATION ONLY NOT FOR MANUFACTURING PURPOSES			UVFS	117 g	1:1	B	