

NUMBER	PART DESCRIPTION	MATERIAL
①	MECHANICAL HOUSING	BLACK ANODIZED ALUMINUM
②	PBS631	N-SF1

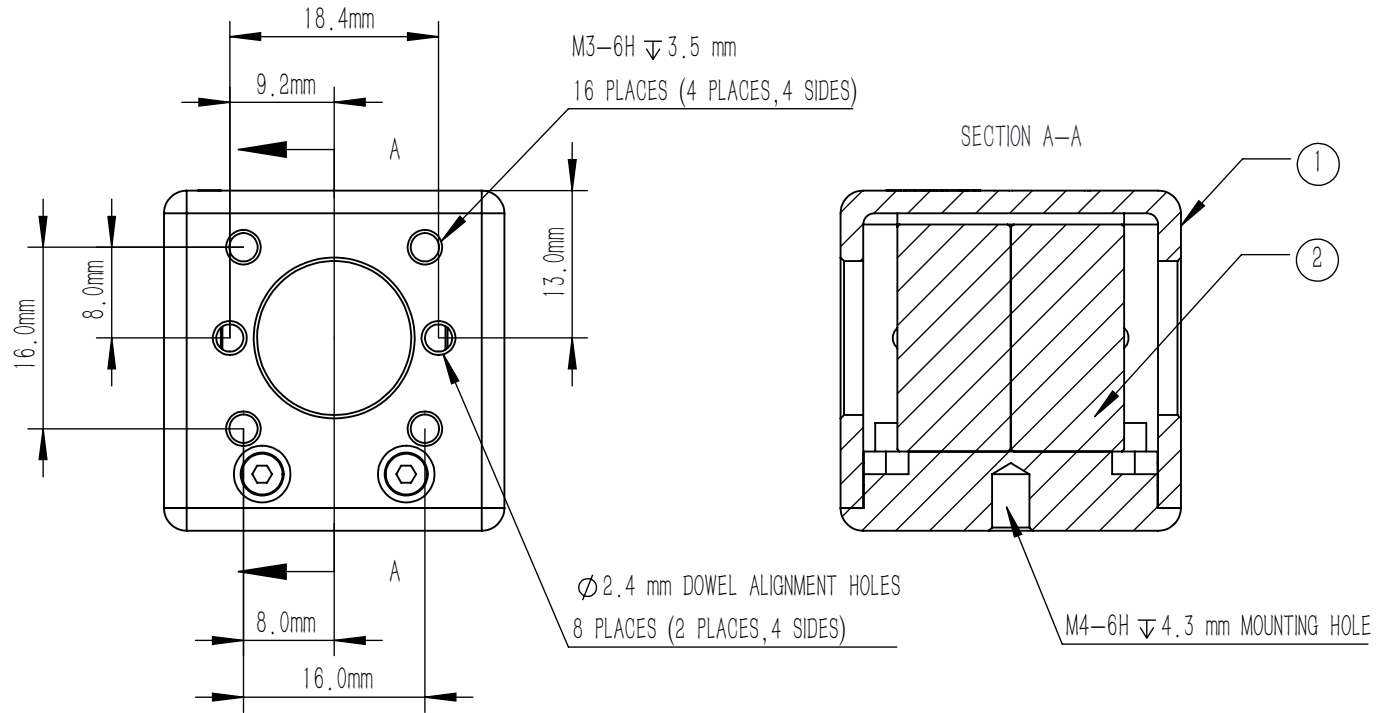

NOTES

PBS631:

- CLEAR APERTURE: $>80\%CA$
- AR COATING(S1, S2, S3, S4): $R_{avg} < 0.5\%$ @420 nm-680 nm (6° AOI, SINGLE SURFACE)
- DIAMETER TOLERANCE: ± 0.25 mm
- ANGLE TOLERANCE: $\pm 1'$
- COATING(S5): $T_p > 90\%$, $R_{s, avg} > 95\%$ @420 nm-680 nm, AOI=45°
- GLUED(S5, S6): NOA61
- EXTINCTION RATIO(T_p, T_s): $> 1000:1$
- TRANSMITTED BEAM DEVIATION: $0^\circ \pm 5$ arcmin
- REFLECTED BEAM DEVIATION: $90^\circ \pm 5$ arcmin
- SURFACE QUALITY(S1, S2, S3, S4): 40/20(S/D)
- TRANSMISSION WAVEFRONT ERROR(RMS): $\lambda/4$ @633 nm
- SURFACE FLATNESS(S1, S2, S3, S4): $\lambda/4$ @633 nm
- OTHER SURFACES: FINE GROUND
- CHAMFER: < 0.5 mm, 45°

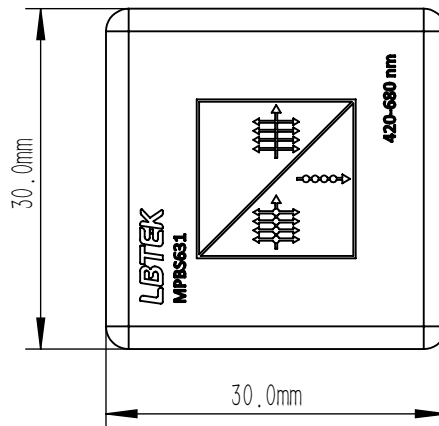

DRAWING PROJECTION		NAME		DATE		PART NUMBER	
		LTAN		Aug./31st/25		MPBS631	
DRAWN		WCHENG		Aug./31st/25		POLARIZATION BEAM SPLITTER L=20.0 mm, $T_p, T_s > 1000:1$ @420 nm-680 nm	
APPROVAL		MATERIAL		WEIGHT		SCALE	
FOR INFORMATION ONLY NOT FOR MANUFACTURING PURPOSES		6061-T6&N-SF1		53.8 g		3:2	
						REV	
						B	

LBTEK