

NUMBER	PART DESCRIPTION	MATERIAL
①	MECHANICAL HOUSING	BLACK ANODIZED ALUMINUM
②	PBS632	N-SF1

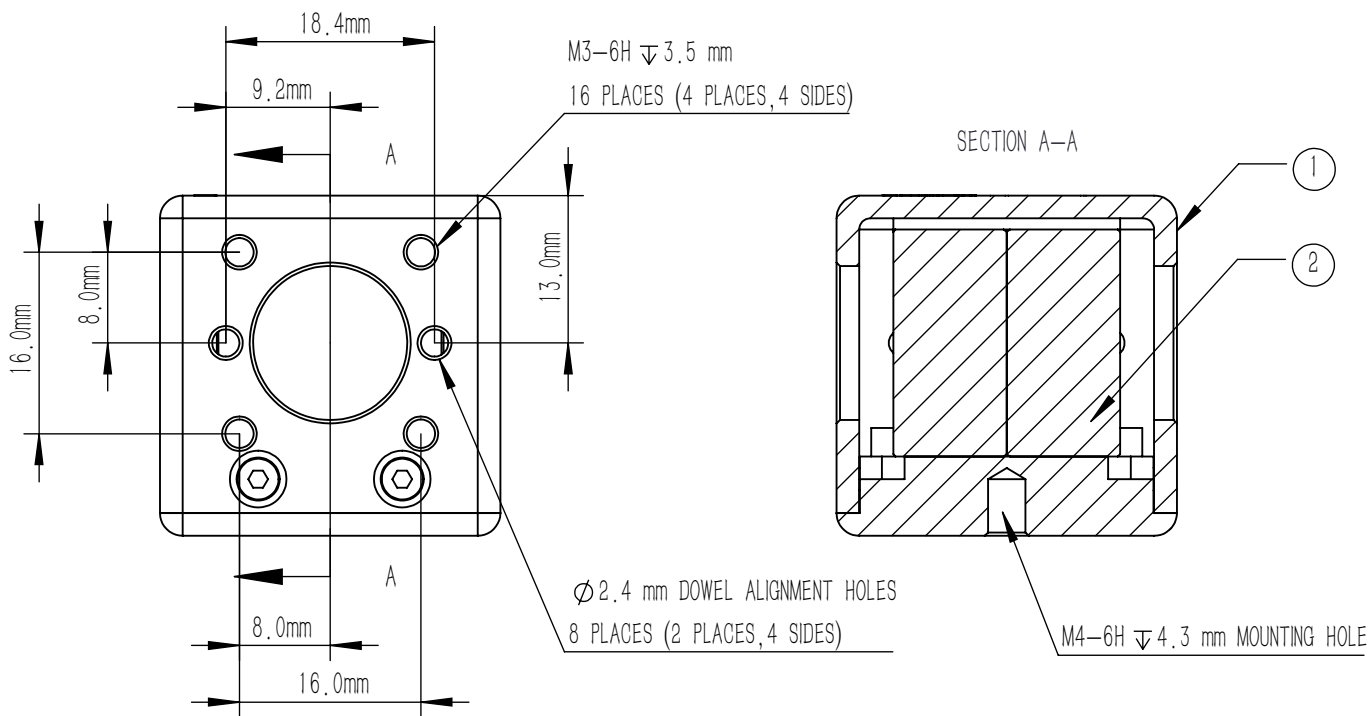

NOTES

- PBS632:
- CLEAR APERTURE: $>80\%$ CA
 - AR COATING(S1, S2, S3, S4): $R_{avg} < 0.5\%$ @620 nm- 1000 nm(6° AOI, SINGLE SURFACE)
 - DIAMETER TOLERANCE: ± 0.25 mm
 - ANGLE TOLERANCE: $\pm 1'$
 - COATING(S5): $T_p > 90\%$, $R_{savg} > 95\%$ @620 nm-1000 nm, AOI=45°
 - GLUED(S5, S6): NOA61
 - EXTINCTION RATIO(T_p : T_s): $>1000:1$
 - TRANSMITTED BEAM DEVIATION: $0^\circ \pm 5$ arcmin
 - REFLECTED BEAM DEVIATION: $90^\circ \pm 5$ arcmin
 - SURFACE QUALITY(S1, S2, S3, S4): 40/20(S/D)
 - TRANSMISSION WAVEFRONT ERROR(RMS): $\lambda/4$ @633 nm
 - SURFACE FLATNESS(S1, S2, S3, S4): $\lambda/4$ @633 nm
 - OTHER SURFACES: FINE GROUND
 - CHAMFER: <0.5 mm, 45°

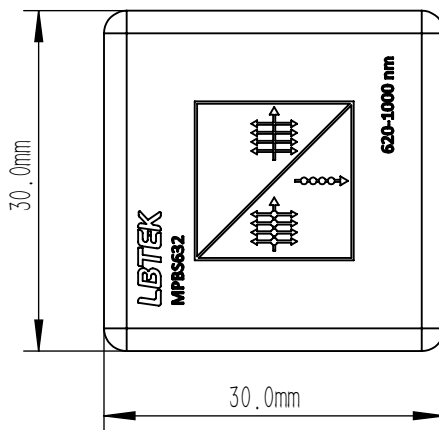

DRAWING PROJECTION			LBTEK			
	NAME	DATE				
DRAWN	LTAN	Aug./31st/25	POLARIZATION BEAM SPLITTER L=20.0 mm, T_p : $T_s > 1000:1$ @620 nm-1000 nm			
APPROVAL	WCHENG	Aug./31st/25	MATERIAL	WEIGHT	SCALE	REV
FOR INFORMATION ONLY NOT FOR MANUFACTURING PURPOSES			6061-T6&N-SF1	53.8 g	3:2	B