

NUMBER	PART DESCRIPTION	MATERIAL
①	MECHANICAL HOUSING	BLACK ANODIZED ALUMINUM
②	PBS643	N-SF1

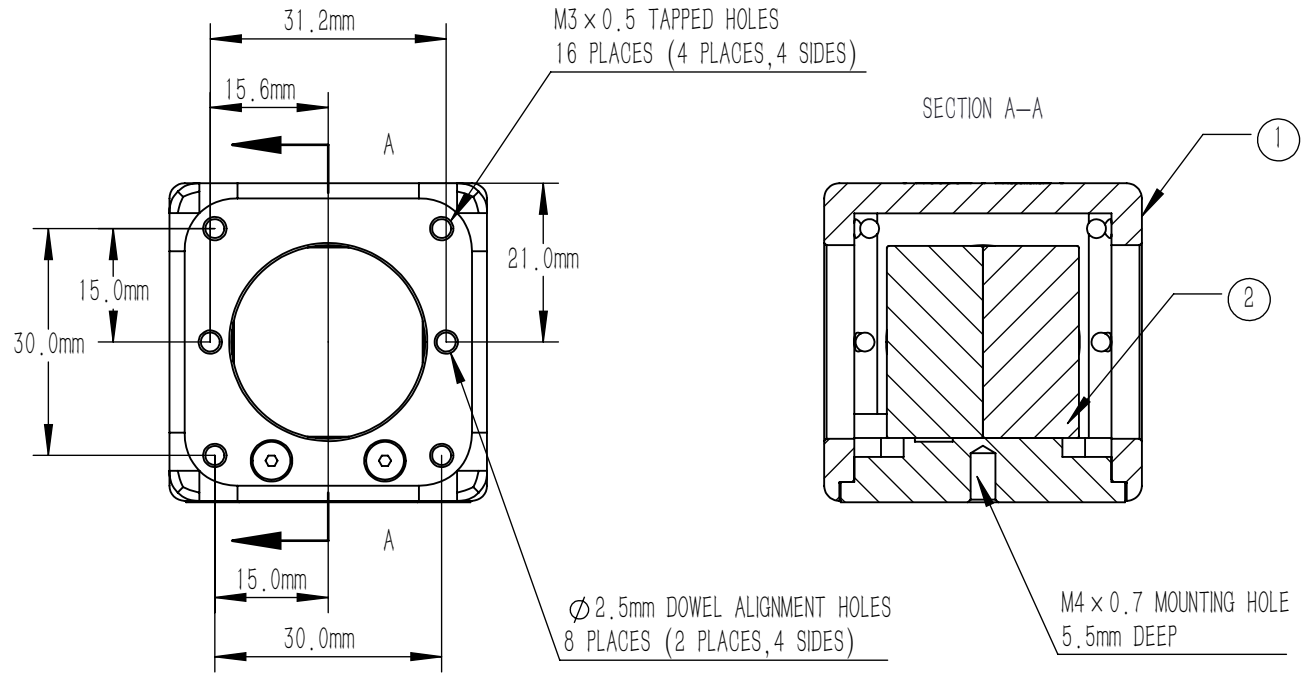
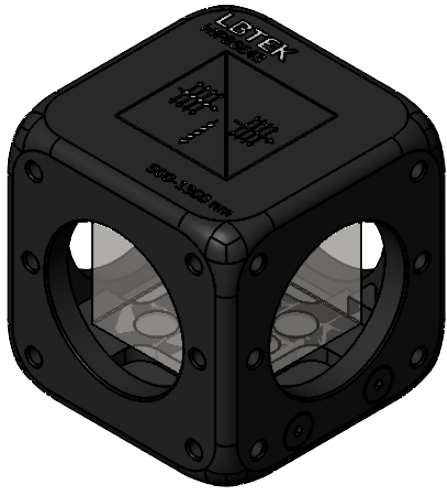

NOTES

PBS643:

- WORKING WAVELENGTH: 900 nm–1300 nm
- CLAER APERTURE: >80%CA
- AR COATING(S1,S2,S3,S4):  $R_{avg} < 0.5\%$  @ 900 nm–1300 nm (6° AOI, SINGLE SURFACE)
- DIAMETER TOLERANCE:  $\pm 0.25$  mm
- ANGLE TOLERANCE:  $\pm 1'$
- COATING(S5):  $T_p > 90\%$ ,  $R_{s,avg} > 95\%$  @ 900 nm–1300 nm, AOI=45°
- GLUED(S5,S6): NOA61
- EXTINCTION RATIO( $T_p, T_s$ ): >1000:1
- TRANSMITTED BEAM DEVIATION:  $0^\circ \pm 5$  arcmin
- REFLECTED BEAM DEVIATION:  $90^\circ \pm 5$  arcmin
- SURFACE QUALITY(S1, S2, S3, S4): 40/20(S/D)
- WAVEFRONT ERROR:  $\lambda/4 @ 633$  nm
- SURFACE FLATNESS(S1, S2, S3, S4):  $\lambda/4 @ 633$  nm
- OTHER SURFACES: FINE GROUND
- CHAMFER: <0.2 mm, 45°

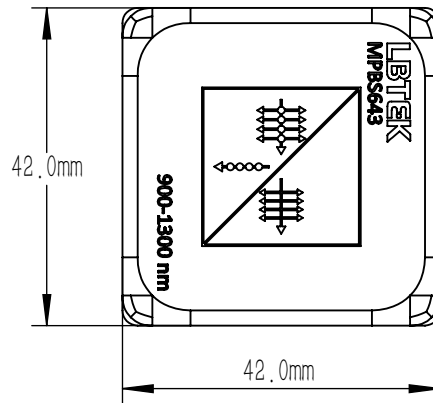

DRAWING PROJECTION			<b>LBTEK</b>			
	NAME	DATE	MPBS643			
DRAWN	LTAN	Aug./31st/25	POLARIZATION BEAM SPLITTER L=25.4 mm, $T_p, T_s > 1000:1 @ 900$ nm–1300 nm			
APPROVAL	WCHENG	Aug./31st/25	MATERIAL	WEIGHT	SCALE	REV
FOR INFORMATION ONLY NOT FOR MANUFACTURING PURPOSES			6061-T6&N-SF1	130 g	1:1	B