

ACCEPTS $\phi 6.0\text{mm}$ [$\phi 0.24\text{in}$] POSTS

$\phi 16.5\text{mm}$
[0.65in]

$\phi 17.0\text{mm}$
[0.67in]

12.7mm
[0.50in]

35.1mm
[1.38in]
16.0mm
[0.63in]

MOUNTING SLOT FOR
M6 CAP SCREWS

12.7mm
[0.50in]

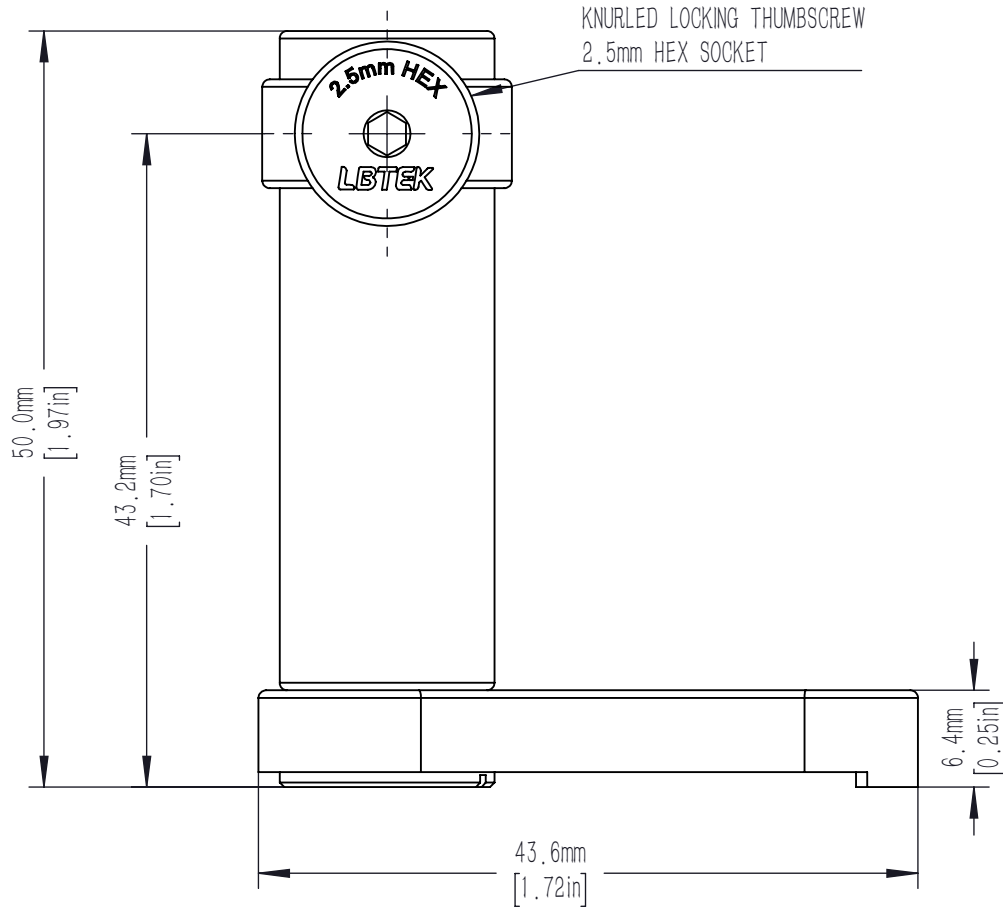

DRAWING PROJECTION			LBTEK			
	NAME	DATE	MPH05-50B6			
DRAWN	ZLI	DEC./12th/23	$\phi 6\text{ mm}$ POST HOLDER			
APPROVAL	HDE	DEC./12th/23	MATERIAL	WEIGHT	SCALE	REV
FOR INFORMATION ONLY NOT FOR MANUFACTURING PURPOSES			N/A	0.026 Kg	2:1	B