

45° VIEW

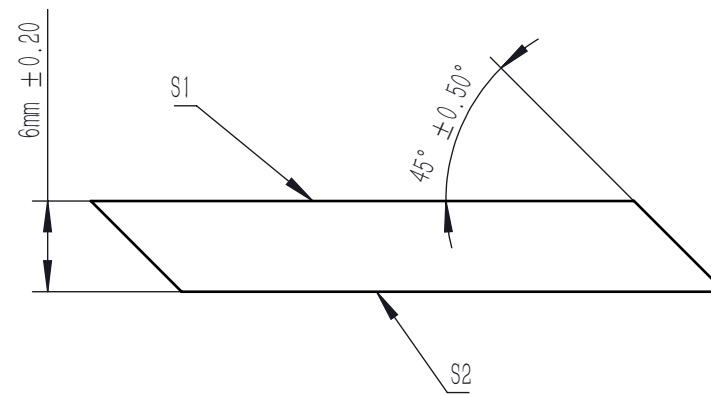
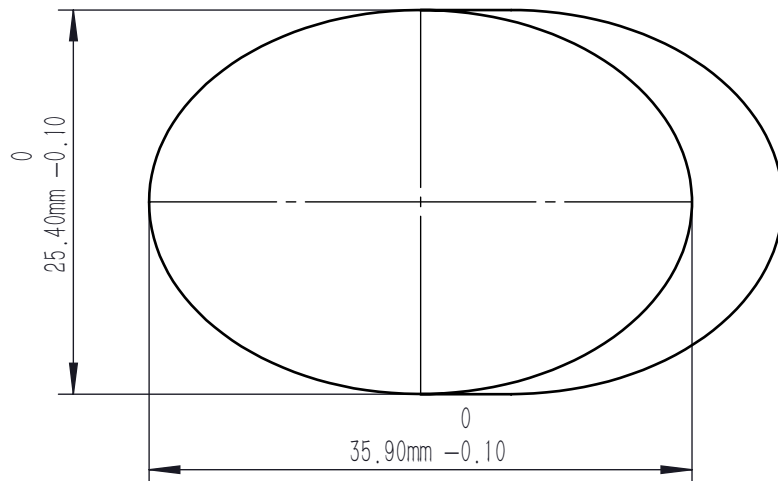

NOTES

1. MATERIAL: UVFS
2. COATING(S1): AG(WITH SILICA PROTECTIVE LAYER)
 $R_{avg} > 96\% @ 450 \text{ nm} - 2.0 \text{ um}, 0^\circ - 45^\circ \text{ AOI}$
 $R_{avg} > 97.5\% @ 2.0 \text{ um} - 20.0 \text{ um}, 0^\circ - 45^\circ \text{ AOI}$
3. CLEAR APERTURE(S1): $> 90\% \text{ CA}$
4. SURFACE QUALITY(S1): 40/20(S/D)
5. SURFACE FLATNESS(S1): $\lambda / 10 @ 633 \text{ nm}$
6. CHAMFER: $< 0.2 \text{ mm}, 45^\circ$
7. BACK SURFACE(S2): FINE GROUND

DRAWING PROJECTION			LBTEK			
	NAME	DATE				
DRAWN	SHAN	JAN. /22th/25	METAL-COATED PLANO MIRROR			
APPROVAL	WCHENG	JAN. /22th/25	MATERIAL	WEIGHT	SCALE	REV
FOR INFORMATION ONLY NOT FOR MANUFACTURING PURPOSES			UVFS	9.5 g	2:1	B