

NOTES:

1. COMPONENT MATERIAL: LCP/N-BK7
2. ELEMENT DIAMETER: $\varnothing 25.4 +0/-0.1$ mm
3. ELEMENT THICKNESS: 3.2 ± 0.1 mm
4. TRIMMING WIDTH: 2.0 ± 0.05 mm
5. CLEAR APERTURE: $\varnothing 20.0$ mm
6. WORKING WAVELENGTH: 633 nm
7. RETARDANCE: $\lambda / 2$
8. SURFACE QUALITY (S/D) : 40/20
9. TRANSMITTANCE: >98 %
10. AR COATING (S1, S2) : $R_{avg} < 0.5 \% @ 400-700$ nm
11. THE FINGER IS PARALLEL TO THE TRIMMING DIRECTION

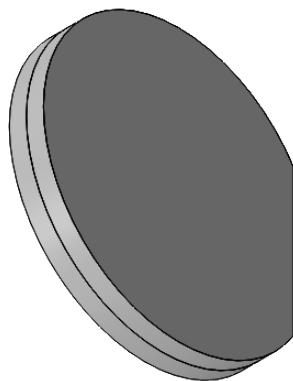

DRAWING PROJECTION			LBTEK			
	NAME	DATE				
DRAWN	SHAN	AUG./16th/24	Polarization Grating			
APPROVAL	WCHENG	AUG./16th/24	MATERIAL	WEIGHT	SCALE	REV
FOR INFORMATION ONLY NOT FOR MANUFACTURING PURPOSES			LCP/N-BK7	4 g	2:1	A