

Ø 23.5mm
[0.93in]
CLEAR APERTURE

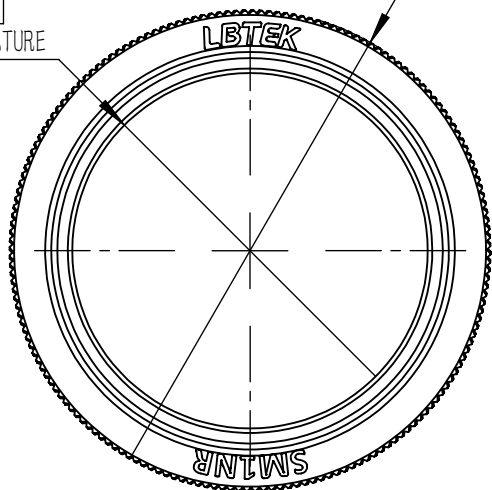

Ø 31.8mm
[1.25in]

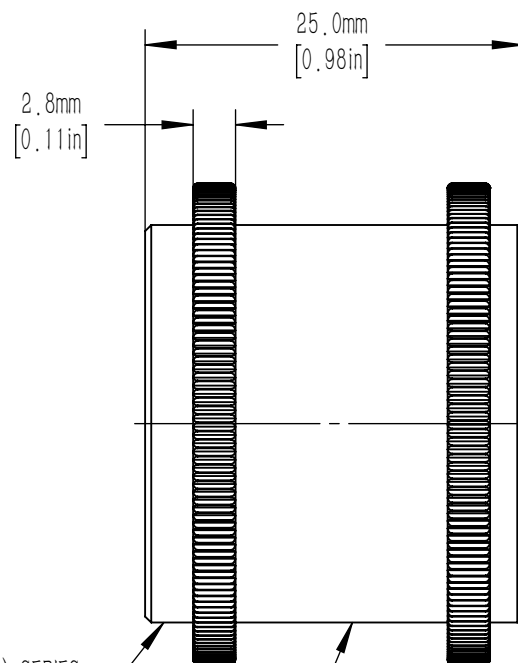

2.8mm
[0.11in]

25.0mm
[0.98in]

SM1 (Ø 1.035-40) SERIES
EXTERNAL THREAD

2 SM1NR LOCKING NUT INCLUDED

ADJUSTMENT SPACING RANGE
5.6mm~21mm(0.22in~0.83in)



DRAWING PROJECTION			LBTEK			
	NAME	DATE	SM1-25T			
DRAWN	YCH	MAR./6th/20	SM1 SERIES EXTERNAL THREAD TUBE			
APPROVAL	ZHE	MAR./6th/20	MATERIAL	WEIGHT	SCALE	REV
FOR INFORMATION ONLY NOT FOR MANUFACTURING PURPOSES			ALUMINUM	0.01 Kg	2:1	B