

Ø 31.8mm
[1.25in]

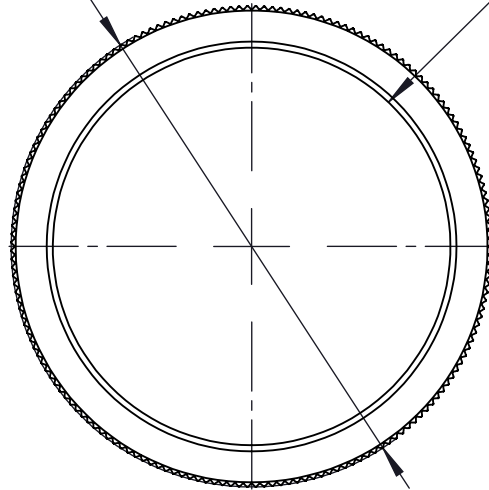

SM1 (Ø 1.035"-40)
INTERNAL THREAD

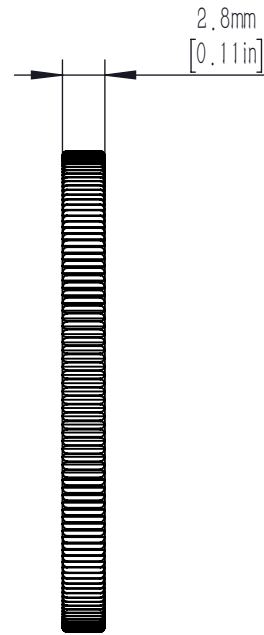

DRAWING PROJECTION			LBTEK			
	NAME	DATE				
DRAWN	BYIN	JUN./25th/19	SM1 SERIES LOCKING NUT			
APPROVAL	LDAI	JUN./25th/19	MATERIAL	WEIGHT	SCALE	REV
FOR INFORMATION ONLY NOT FOR MANUFACTURING PURPOSES			ALUMINIUM	0.002 Kg	2:1	B