

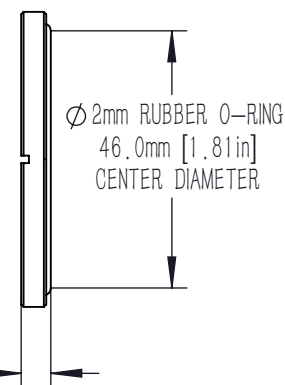

SM2 (ϕ 2.035-40) SERIES
EXTERNAL THREAD

ϕ 42.7mm [1.68in]
CLEAR APERTURE

1mm [0.04in]
SPANNER WRENCH SLOTS
FOR USING WITH OWR-2A

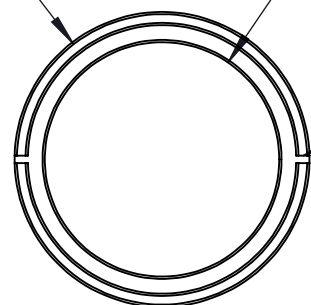

4.0mm [0.16in] - 4.2mm [0.17in]

ϕ 2mm RUBBER O-RING
46.0mm [1.81in]
CENTER DIAMETER

DRAWING PROJECTION			LBTEK			
	NAME	DATE	SM2RSF			
DRAWN	ZZH	NOV./10th/25	SM2 STRESS REDUCING RETAINING RING			
APPROVAL	YLI	NOV./10th/25	MATERIAL	WEIGHT	SCALE	REV
FOR INFORMATION ONLY NOT FOR MANUFACTURING PURPOSES			N/A	0.003 Kg	1:1	A